



10-TON PUSH PULLER

Part No. **18100**

Warning:



Safety Warning:

Read all instructions and warnings before attempting to use this product.

Failure to comply can result in damage, injury, or possibly death.

Consult the vehicle's service manual before using this product for specific removal instructions.

Note: Hammering this tool will void the warranty.

Operating Instructions:

1. Determine if the forcing screw (18102) will be used to push or pull.
2. If the forcing screw (18102) will be used to push/remove a gear from a shaft:
 - a. Insert forcing screw (18102) into the H type yoke (18101) with the forcing screw washer (18103) and forcing screw nut (18104) connected below the H type yoke (18101).
 - b. Slide the push puller legs (18105) into both sides of the H type yoke (18101) with the sliding plate washers (18106) and the leg nuts (18108) connected above the H type yoke (18101) and the leg washers (18107) connected below the H type yoke (18101).
3. If the forcing screw (18102) will be used to pull/remove a shaft from a housing:
 - a. Insert forcing screw (18102) into the H type yoke (18101) with the forcing screw washer (18103) and forcing screw nut (18104) connected above the H type yoke (18101).
 - b. Slide the push puller legs (18105) into both sides of the H type yoke (18101) with the leg nuts (18108) and leg washers (18107) connected above the H type yoke (18101) and the sliding plate washers (18106) connected below the H type yoke (18101).

Note: Lubricate the forcing screw (18102) regularly to maintain operation of tool.

Parts Breakdown:

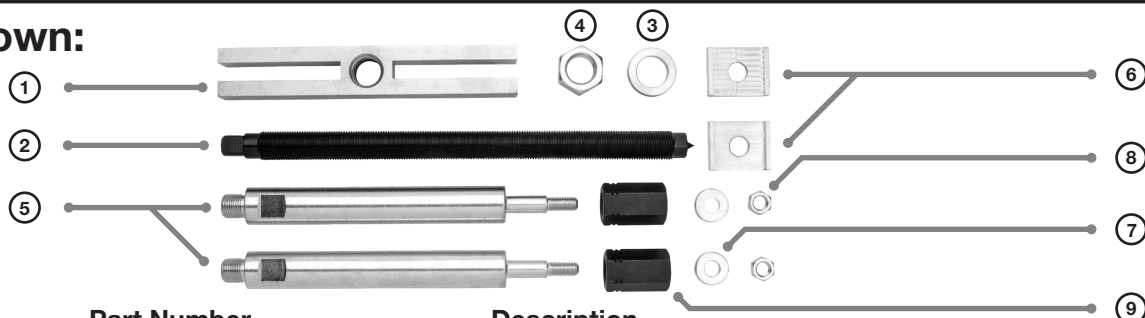

Figure Number	Part Number	Description	Qty.
1	18101	H Type Yoke	1
2	18102	Forcing Screw	1
3	18103	Forcing Screw Washer	1
4	18104	Forcing Screw Nut	1
5	18105	Push Puller Leg	2
6	18106	Sliding Plate Washer	2
7	18107	Leg Washer	2
8	18108	Leg Nut	2
9	18109	Leg Adapter	2