

SHEPPARD M100 PITMAN ARM PULLER

Safety Warning:

Read all instructions and warnings before attempting to use this product.  
Failure to comply can result in damage, injury, or possibly death.  
Consult the vehicle's service manual before using this product for specific removal instructions.

- Stay alert! Be aware of your surroundings and use common sense when operating this tool.
  - Inspect tool for damage prior to using; do not use if tool is in unsafe condition.
- Always use safety equipment. Approved face and eye protection must be worn in the work area at all times.
  - Keep hair, clothing, jewelry, and gloves away from any moving parts at all times.

**Note:** Hammering this tool will void the warranty.

Operating Instructions:

1. With a punch, bend the locking tabs away from the retaining bolt.
2. Loosen and remove the retaining bolt with an Allen wrench or bit.
3. Lubricate the center screw threads and the point of contact where the center screw and the sector shaft will meet.
4. Reverse the center screw, allowing enough space for the cup to go over the pitman arm, then slide the tool over the pitman arm.
5. Tighten the center screw by hand, keeping it aligned and centered on the sector shaft.  
**Note:** Be sure the tool has sufficient contact with the pitman arm to avoid slippage during the next step.
6. While maintaining proper alignment, turn the center screw with an 1/2" drive impact to remove the arm from the sector shaft.

Parts Breakdown:

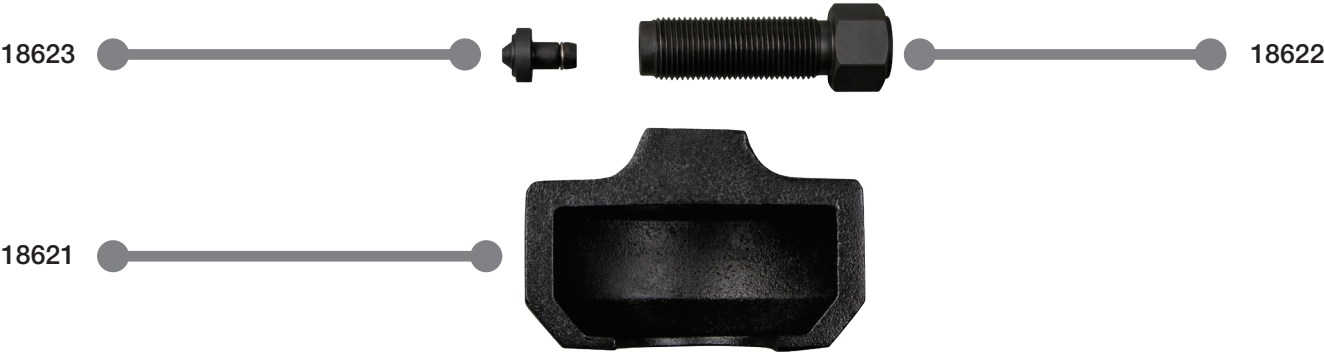

Part Number	Description	Qty.
18621	Body Sheppard M100	1
18622	Forcing Screw M100	1
18623	Push Cone/W O-Ring M100	1